

Description de l'article/illustrations du produit



Description

Matière :
Acier 1.7225.

Finition :
Naturel.

Nota :
Axes de guidage pour le guidage des ressorts. Ceux-ci déterminent la position des ressorts et empêchent toute déformation latérale.

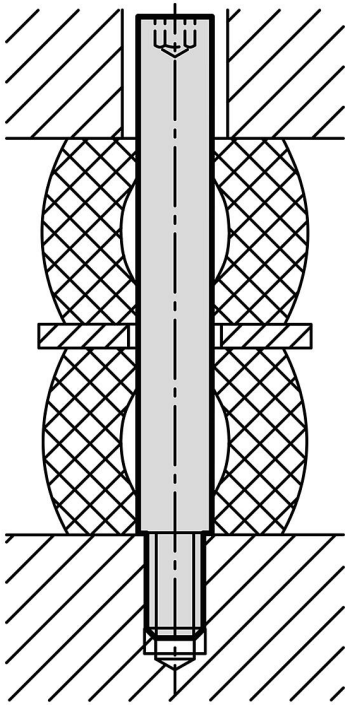

Dessins

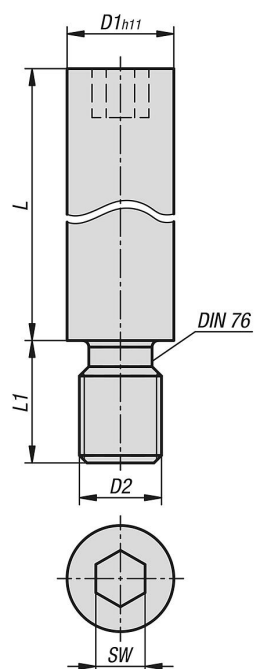

Aperçu des articles

Référence	D1	D2	L	L1	SW
26095-02-06X020	6	M4	20	6	3
26095-02-06X025	6	M4	25	6	3
26095-02-06X032	6	M4	32	6	3
26095-02-08X020	8	M6	20	9	4
26095-02-08X025	8	M6	25	9	4
26095-02-08X032	8	M6	32	9	4
26095-02-08X040	8	M6	40	9	4
26095-02-08X050	8	M6	50	9	4
26095-02-10X020	10	M8	20	15	5
26095-02-10X025	10	M8	25	15	5
26095-02-10X032	10	M8	32	15	5
26095-02-10X040	10	M8	40	15	5
26095-02-10X050	10	M8	50	15	5
26095-02-10X063	10	M8	63	15	5
26095-02-13X032	13	M10	32	15	6
26095-02-13X040	13	M10	40	15	6
26095-02-13X050	13	M10	50	15	6
26095-02-13X063	13	M10	63	15	6
26095-02-13X080	13	M10	80	15	6
26095-02-13X095	13	M10	95	15	6
26095-02-16X032	16	M12	32	18	8
26095-02-16X040	16	M12	40	18	8
26095-02-16X050	16	M12	50	18	8
26095-02-16X063	16	M12	63	18	8
26095-02-16X080	16	M12	80	18	8
26095-02-16X095	16	M12	95	18	8
26095-02-16X118	16	M12	118	18	8
26095-02-16X140	16	M12	140	18	8
26095-02-20X050	20	M16	50	25	10
26095-02-20X063	20	M16	63	25	10
26095-02-20X080	20	M16	80	25	10
26095-02-20X095	20	M16	95	25	10
26095-02-20X118	20	M16	118	25	10
26095-02-20X140	20	M16	140	25	10
26095-02-25X050	25	M20	50	30	14
26095-02-25X063	25	M20	63	30	14
26095-02-25X080	25	M20	80	30	14
26095-02-25X095	25	M20	95	30	14
26095-02-25X118	25	M20	118	30	14
26095-02-25X140	25	M20	140	30	14
26095-02-25X180	25	M20	180	30	14